

- Tube Fitting (Double Ferrule)-
Tube To Female Pipe Thread

Female Branch Tee

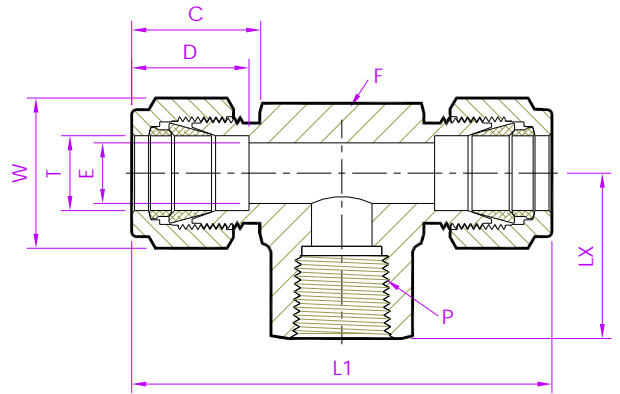
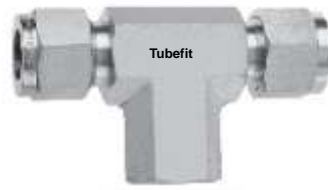

Metric Tube x NPT (F)

Tubefit Part No.	Equivalent Part No. Type 1	Equivalent Part No. Type 2	TUBE OD Ø T	NPT Female Pipe Size P	ØE	D	C	L1	LX	Body Hex F	Nut Hex W
			(mm)	(In)	Dimensions in Millimetres						
6M - FBTD - 2N	- 6MO - 3 - 2TTF	M6FBT1/8N	6	1/8	4.8	15.3	17.7	53.9	19.0	14.2	14.2
6M - FBTD - 4N	- 6MO - 3 - 4TTF	M6FBT1/4N		1/4	4.8			59.5	22.4	19	
8M - FBTD - 2N	- 8MO - 3 - 2TTF	M8FBT1/8N	8	1/8	6.4	16.2	18.6	59.7	19.0	16	16
8M - FBTD - 4N	- 8MO - 3 - 4TTF	-----		1/4	6.4			61.2	22.4	19	
10M - FBTD - 4N	- 10MO - 3 - 4TTF	M10FBT1/4N	10	1/4	7.9	17.2	19.5	67.0	22.4	19	19
12M - FBTD - 2N	- 12MO - 3 - 2TTF	M12FBT1/8N	12	1/8	8.3	22.8	22.0	72.0	22.3	22.2	22.2
12M - FBTD - 4N	- 12MO - 3 - 4TTF	M12FBT1/4N		1/4	9.5			72.0	22.4	22.2	
12M - FBTD - 6N	- 12MO - 3 - 6TTF	M12FBT3/8N		3/8	9.5			72.0	22.4	22.2	
12M - FBTD - 8N	- 12MO - 3 - 8TTF	M12FBT1/2N		1/2	9.5			77.6	28.5	27	
16M - FBTD - 8N	- 16MO - 3 - 8TTF	M16FBT1/2N	16	1/2	12.7	24.4	22.0	77.6	28.4	27	25

NOTE : 1)The E Dimension is the minimum opening. 2)Dimension L1, C, D is shown in the finger-tight position.
3)Dimensions are for reference only and are subject to change 4)NPT thread as per ANSI B 1.20.1.

- ALL PART NUMBERS ARE PROPRIETARY OF THEIR RESPECTIVE OWNERS. -